

PERGOLAS & OUTDOOR FURNITURE COLLECTIONS



CONTENTS

We are Suns Lifestyle	04
A true extension of your home	06
Our Pergolas	08
Alvaro Louvered Pergola	14
Maranza Louvered Pergola	18
Rota Louvered Pergola	22
How to measure your space	26
Pergola Comparison Guide	28
Our Pergola Promise	30
Under the Pergola.....	32
Product Quality.....	50

WE ARE SUNSLIFESTYLE

We are a British, independently-owned outdoor lifestyle company committed to bringing you premium, fully-weatherproof pergolas and furniture collections ready to transform your garden.

Designed for life outdoors, our products combine innovative, consciously-sourced materials with robust construction techniques. Offering low-maintenance, stylish design and unrivalled quality.

Our team of experts are on hand to support you with your project, large or small. Creating a bespoke outdoor space to enjoy season after season.

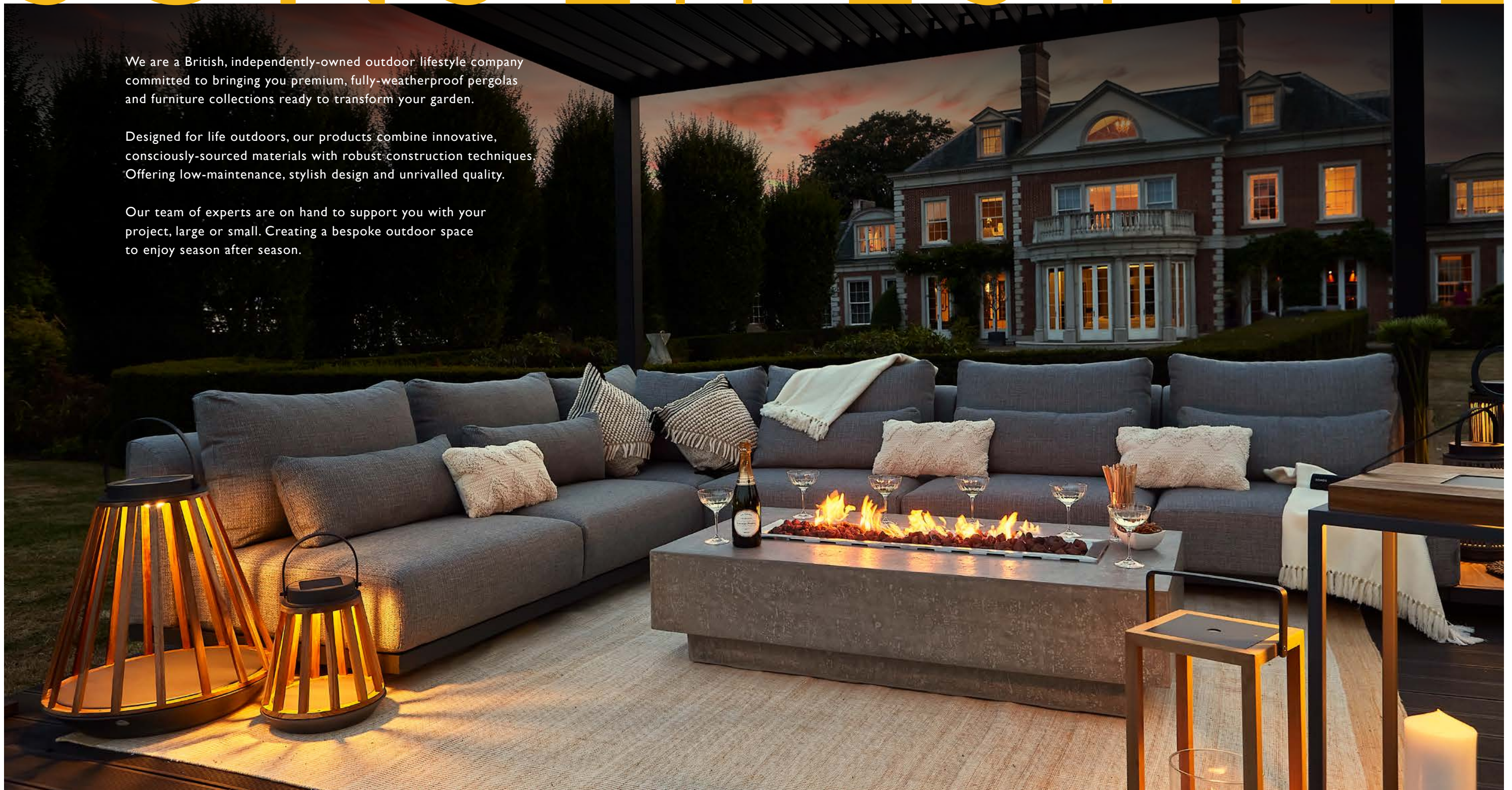

A TRUE EXTENSION OF YOUR HOME

The garden is an integral part of your home and can be enjoyed in many different ways. If you love the al fresco lifestyle and you want to make the most of your outdoor space, a pergola is an excellent investment. These ready-to-use structures often do not require any planning permission and can be placed freestanding or as an overhang from your home or garden building.

The Suns Lifestyle louvered pergola collections offer innovative models, in a market-leading range of sizes. It couldn't be easier to create a stylish, contemporary all-season shelter at home.



OUR PERGOLAS

These functional and ready-to-use terrace-coverings are an excellent way of enhancing your outdoor space for all-year-round use. The Suns Lifestyle collection of aluminium pergolas are available in a range of sizes and configurations to create a distinct and contemporary look at home.

The key feature in the pergola's unique design is the roof louvers, the manual winding mechanisms allow you to control the direction of the roof louvers creating an open or closed space. The genius built-in drainage system means that if the weather changes, just close the louvered roof to make the area weatherproof, any rainwater that lands on the louvers will flow into the guttering channels and drain through the legs to the ground.

Flexible side options offer more shelter, shade and comfort giving an all-season weatherproof area.

SCAN TO EXPLORE PERGOLAS



Scan here to discover our full range of pergolas

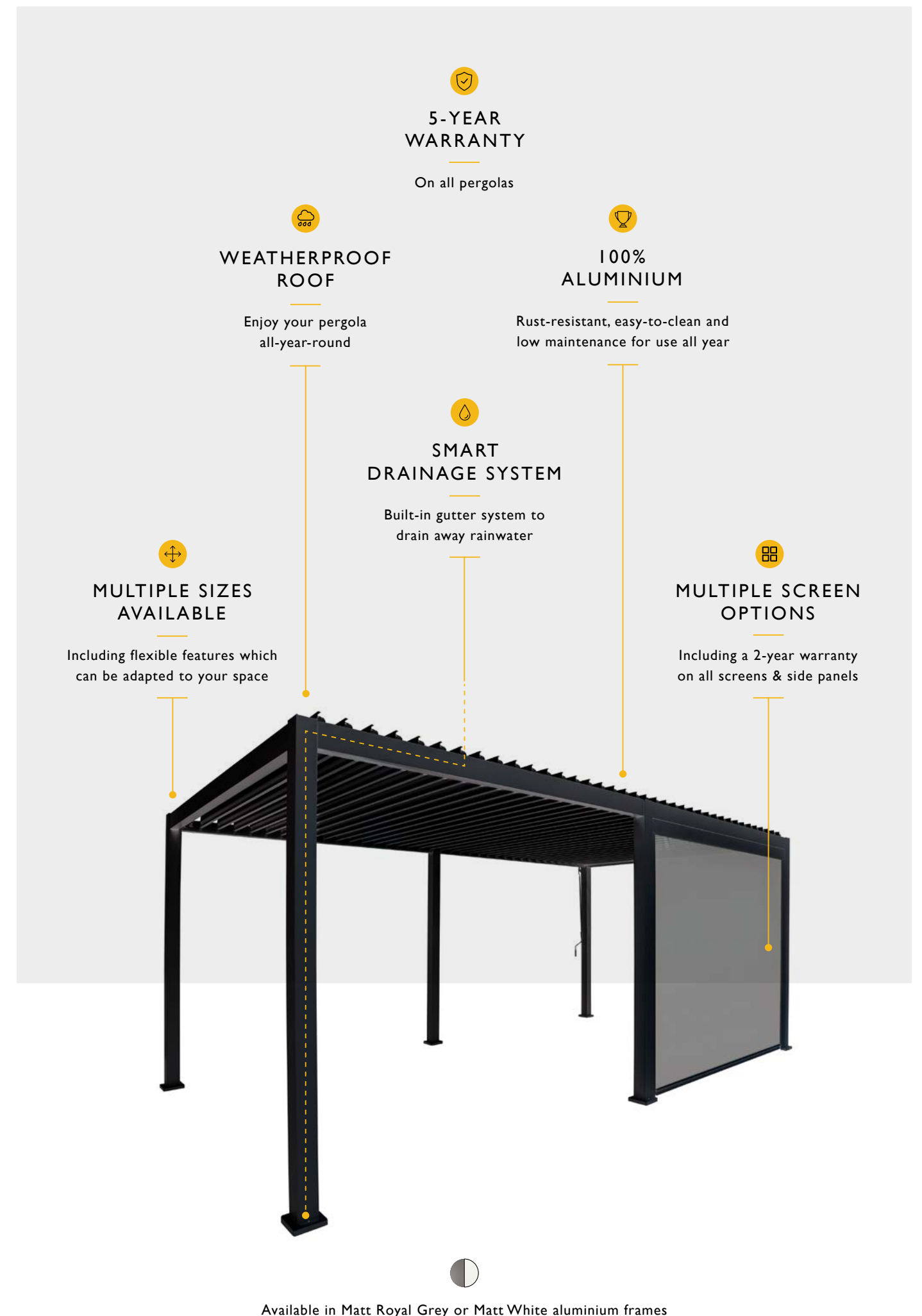

IT'S ALL IN THE DETAIL

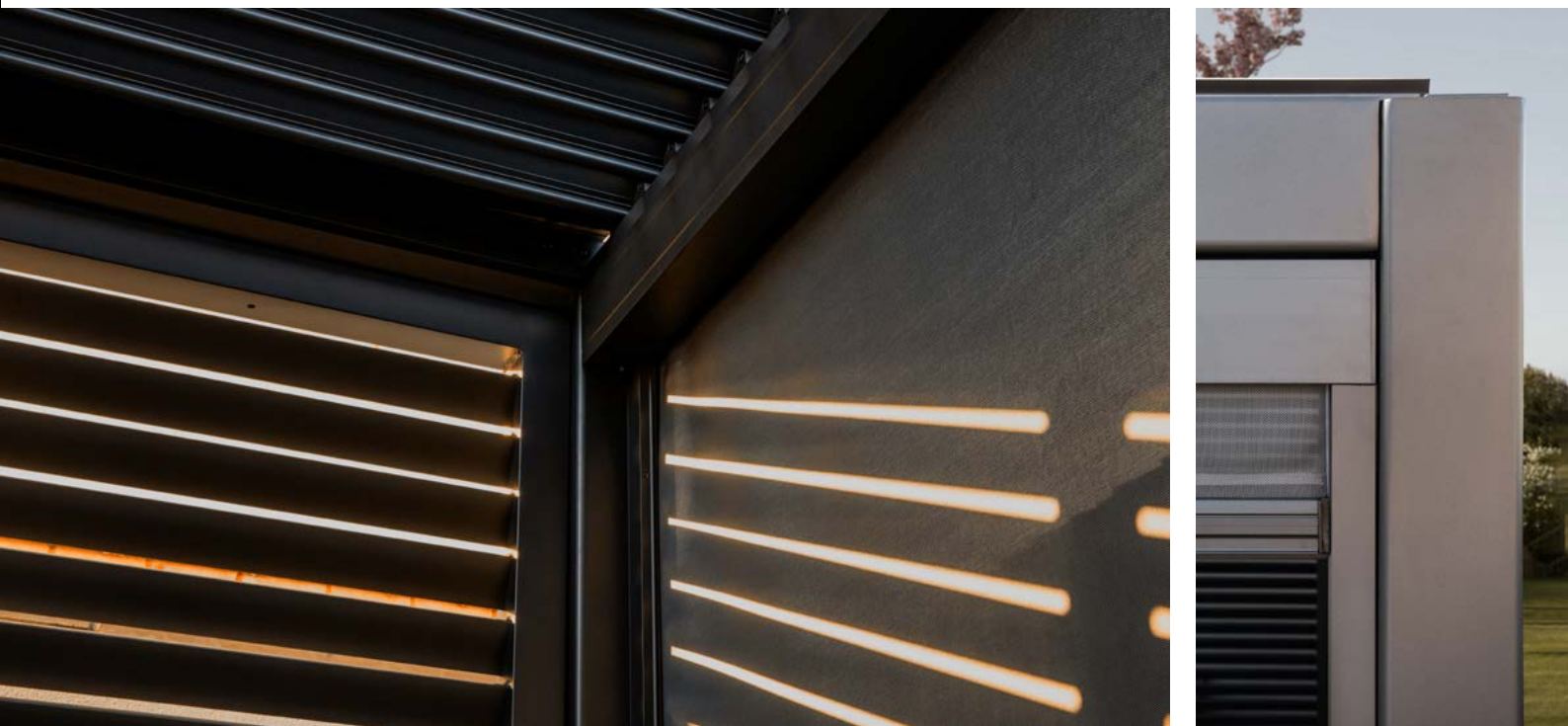

WHY CHOOSE A SUNS LIFESTYLE PERGOLA?

All of our pergolas are made from high quality 100% rust-resistant aluminium, they come in a range of sizes and heights to offer solutions for every garden project. The components of our pergolas are often heavier than others because of the aluminium grade and density. This is why we offer a professional nationwide installation service for our outdoor structures, ensuring each one is safely constructed, with all screen components working and fixed securely to your foundations to withstand the elements for year-round enjoyment.

OPTIONAL SIDES

When it comes to shade and shelter, no pergola is complete without screens. We offer innovative, weatherproof Deluxe screens on our popular Maranza, Rota and Alvaro pergolas. Designed for life outdoors, our Deluxe screens are made from an innovative, weighted UV, fade-resistant fabric, they zip-lock to the side of the leg for robust protection from the wind and rain on all sides. You won't find any fiddly winders or rods on our screens either, instead our Deluxe screens have in-built tension so you can stop them at any point

for protection to suit you, or retract fully into their cassettes for a seamless finish when you want to enjoy the sun.

LOUVERED MECHANISM

Most of our pergolas are manual louvered models, we do offer electric retractable options but for polished, contemporary good looks (and amazing value for the quality) we don't think you can beat the streamlined finish on a manual louvered pergola. The winding mechanism for the roof blades is neatly concealed to one side and a clever hidden drainage system that carries rainwater off the roof, into channels and down inside the legs. It's worth noting that the roof blades on all of our pergolas are double layered meaning they can withstand higher rainfall versus single skin options found elsewhere.

READY TO SHOP?

Explore our range of pergolas on page 29.

You can also explore our range on our website, sunslifestyle.com where you can find plenty of useful information on finding the perfect pergola for your space, along with inspiration on how to style your pergola.

OUR SCREENS

Made from double-layered Textilene, we're really proud of our weatherproof screens.

Held in cassettes that fit seamlessly into the pergola frame, they slide down tracks in the legs to give you shade, shelter or sun whenever you want or need it.

You won't find any brackets to hold them or gaps along the edge.

With a ziplock function that anchors into the base of the leg, our robust screens are an excellent investment for those bringing the indoors out.

The robust fabric is water-repellent, fade and mould-resistant making our screens durable and easy to clean.



BRING THE INSIDE OUT

Our louvered aluminium pergolas are available as both freestanding and wall-mounted options. Ideal when you want to seamlessly transition outside.

When fixing to the external wall, often we can remove the middle leg to accommodate bifold doors. Having a pergola over bifolds can really reduce heat transfer and glare, often making it a more attractive and practical alternative to blinds.

Our in-house installation teams are experts when it comes to the orientation and positioning of our pergolas, so any questions they'll be happy to advise.



THE FINISHING TOUCHES

We're sticklers for detail, it truly sets our products apart. Combining reliable design with ease of function, our pergolas come with footplates to cover unsightly bolts when drilled to the surface and double-skinned roof blades to keep the pergola weatherproof.

We work with robust, industrial grade aluminium which is why you'll find that the component parts might be heavier than other models in market.

When shopping around, here's our pre pergola checklist:

- ✓ Can the company offer guidance on foundations?
- ✓ Can the company provide floorplans for leg placement and orientation?
- ✓ Check the company you're purchasing from can install for you.
- ✓ Do they have an in-house installation team (not delivery drivers)
- ✓ Does the company have customer images of jobs they've installed already?
- ✓ Does the company have insurance to install your pergola properly?
- ✓ Will they bolt down for you? This is vital for a secure structure.
- ✓ Does the company physically stock the product?
- ✓ Does the company have first hand product knowledge?
- ✓ Is the company based in the UK?

At Suns Lifestyle we confidently fulfil all of the above, our installation service is tried and tested with over 3500 happy customers and we're used to working with our customers on the best solution for their outdoor space.

AL

LOUVERED
PERGOLA

The incredibly designed Suns Lifestyle Alvaro Pergola offers features that adapt to any size, space and season so you can make the most of the outdoors all year round.

Infinitely extendable lengthways, and with our signature manual louvered roof shutters — create customisable shade and shelter whenever you need it. Add Deluxe screens for a fully weatherproof, luxury extension of your home.

THE

ALVARO



SCREEN OPTIONS

- Weatherproof Deluxe screens
- Aluminium vented panels (0.93m)
- Solid panels (0.31m)

MULTIPLE SIZES

Height	2.50m	
Dimensions	3.6 x 3.0m	3.6 x 4.0m
	3.6 x 6.0m	3.6 x 7.0m
	3.6 x 8.0m	3.6 x 9.0m
	3.6 x 10.0m	3.6 x 11.0m
	3.6 x 12.0m	3.6 x ∞

The image shown measures 3.6 x 12.0m



The Alvaro Louvered Pergola width is fixed at 3.6m but with the extension kits you can extend the length as much as you like!

DIMENSIONS

Top height of roof beam	2.50m
Underside of roof beam	2.35m
Louvers fully open	2.57m



INFINITE EXTENSION

The Alvaro Louvered Pergola is infinitely extendable lengthways by connecting the base models, creating custom-size larger structures to fit your space.

The width is fixed at 3.6m but choose our 3.0m or 4.0m kits to connect seamlessly to your base pergola to create a truly bespoke size — perfect for larger projects.

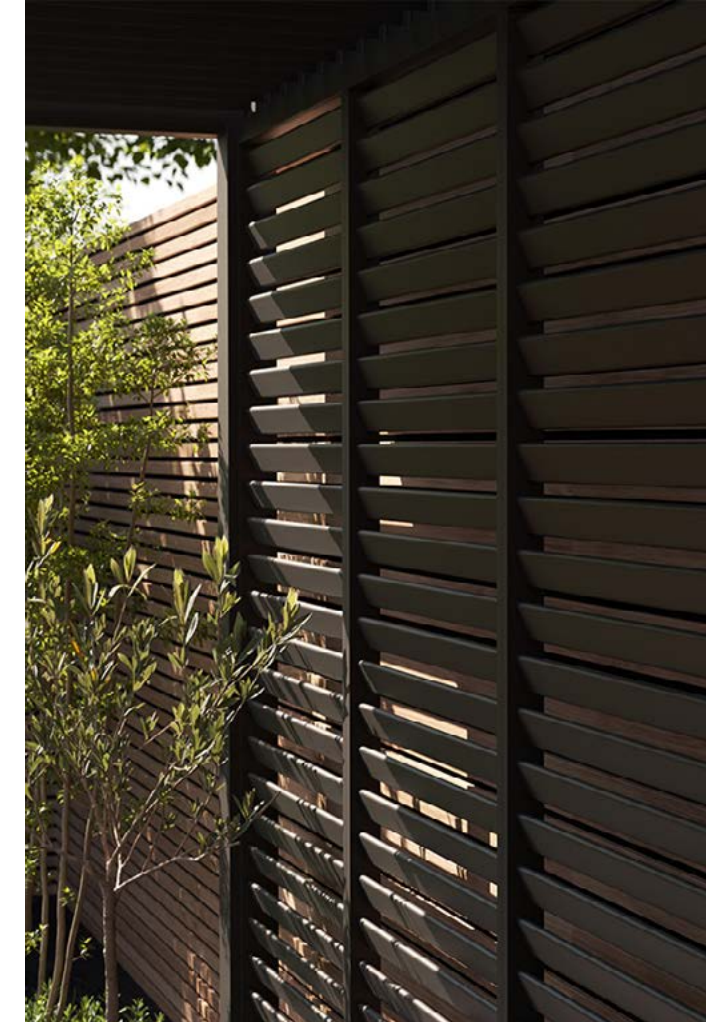
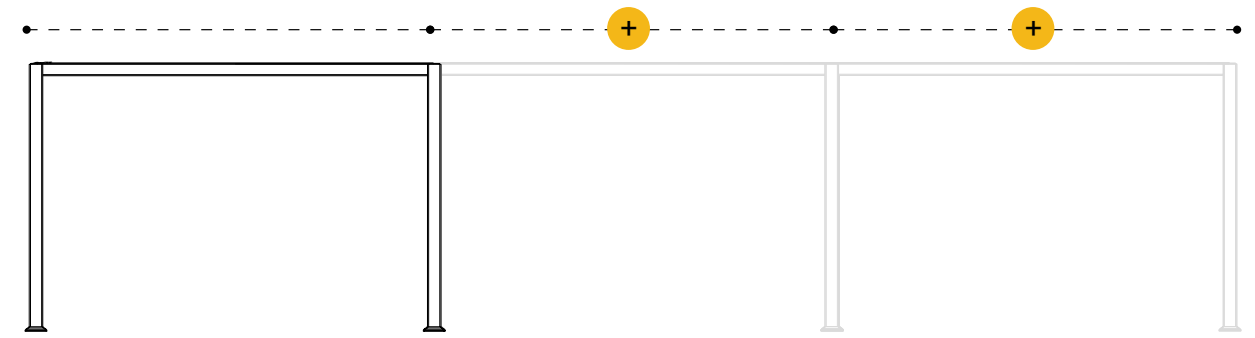

THE MARANZA

LOUVERED PERGOLA

Create your perfect outdoor retreat with the Maranza Louvered Pergola – perhaps an al fresco space to entertain, a cosy area for a corner sofa or a cover for your hot tub. Ideally suited as a freestanding structure offering a 4-sided solution to your outdoor living space.



INDEPENDENT SECTIONS

Each roof section operates independently offering flexibility to let the sun in across the whole roof or just each section.





MANUAL LOUVERED ROOF

Sun or shade, wet or dry: you decide!

WEATHERPROOF ROOF

Shelter from the rain with a weatherproof roof and smart drainage system; rain runs into the concealed gutter and drains internally through the legs.

OPTIONAL SIDES

Easy pull-down Deluxe screens offer robust protection from the sun, wind and rain. Or choose an aluminium vented panel for a stunning, contemporary backdrop.

- Weatherproof Deluxe screens
- Aluminium vented panels

FOOTPLATE

Our pergolas are secured to the ground using a footplate, with a cover applied over the top to conceal the connections. This means all of our pergolas have a clean finish with no unsightly bolts.

MULTIPLE SIZES

Height: 2.30m

3.0 x 3.0m	3.5 x 5.4m
3.0 x 3.6m	3.5 x 7.2m
3.5 x 3.6m	

DIMENSIONS

Top height of roof beam	2.30m
Underside of roof beam	2.16m
Louvers fully open	2.34m

Maximum clearance for doors to open underneath is 2.12m

WE RECOMMEND

If you need a higher external door clearance than 2.12m, take a look at our taller Rota or Alvaro models.

THE ROTA

LOUVERED PERGOLA



The Rota stands 20cm taller than the Maranza which makes it a perfect overhang above bi-fold doors. The construction of an outdoor terraced area is no longer a complicated building project, this is a smart solution with a long lifespan. The manual louvers open fully vertically on the Rota and they conveniently move as one system on the 4-leg models, or dual on 6-leg models for bespoke shade and shelter.

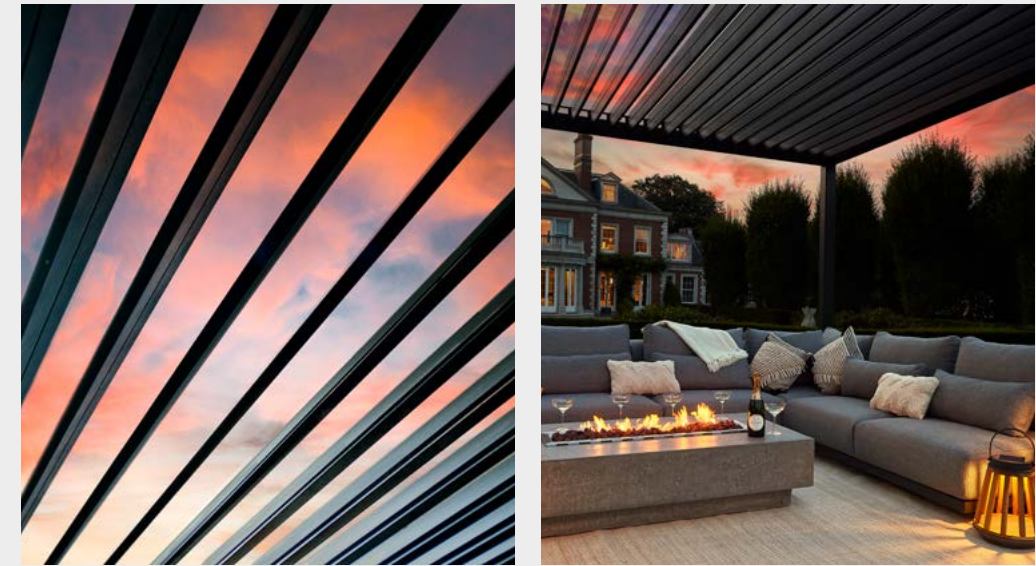

MULTIPLE SIZES

Height: 2.50m

3.0 x 3.0m	3.0 x 6.0m	3.6 x 5.3m
3.0 x 3.6m	3.6 x 3.6m	3.6 x 6.0m
3.0 x 4.0m	3.6 x 4.0m	3.6 x 7.2m

DIMENSIONS

Top height of roof beam	2.50m
-------------------------	-------

Underside of roof beam	2.35m
------------------------	-------

Louvers fully open	2.57m
--------------------	-------

Maximum clearance for doors to open underneath is 2.35m

SCREEN OPTIONS

Weatherproof Deluxe screens can be added to all sides of the pergola, if required.

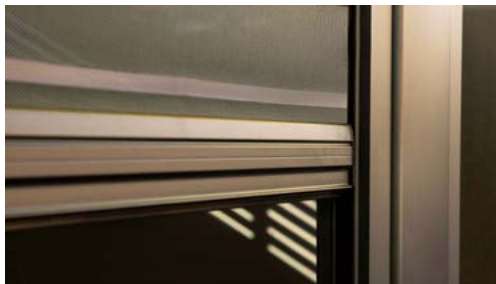

NOT SURE WHICH PERGOLA IS FOR YOU?

Take a look at our Pergola Comparison Guide on page 29, or get in touch with our expert team to discuss your pergola requirements in more detail.



HOW TO MEASURE YOUR SPACE

Before choosing your pergola it's important to measure where it will sit to ensure it fits your space perfectly. First, you need to decide where you would like your pergola positioned — freestanding or against your home. Our handy measuring guide will help guide you on how to measure your space in each of these scenarios. We recommend taking all measurements in centimetres.

If you need some assistance in deciding which pergola is right for you, you can send your measurements, along with any photos to us at survey@sunslifestyle.com

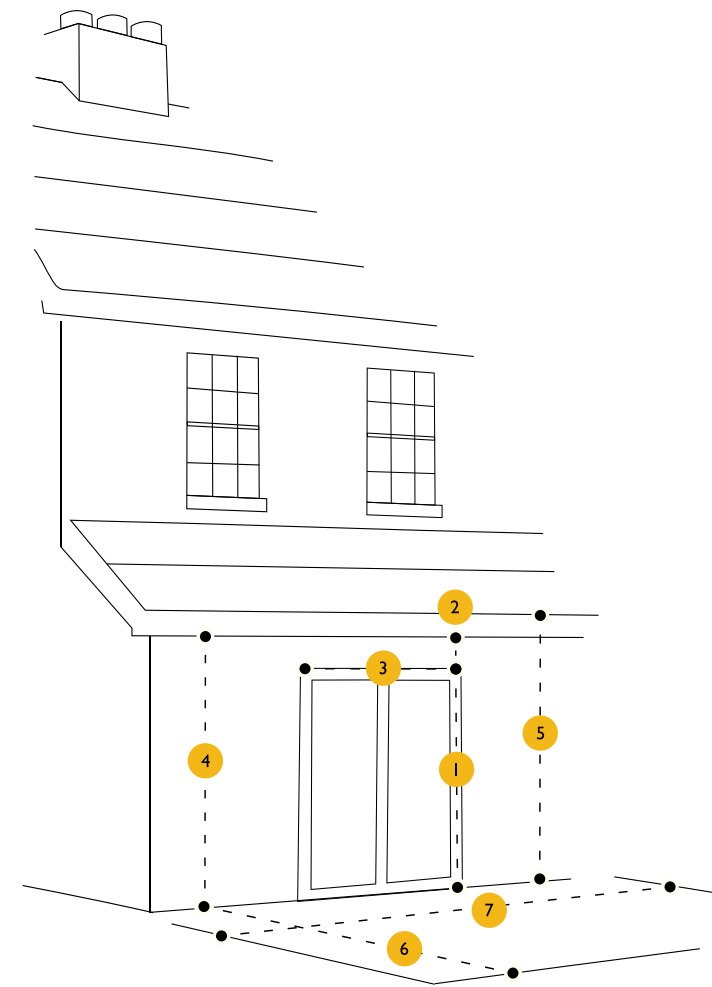

AGAINST YOUR HOME

1. Measure from the top of your doors to the patio floor
 2. Measure the brick/stonework between the top of your doors and soffit (if there is one)
 3. Measure patio door width
 4. Measure the patio floor to the underside of soffit (if there is one)
 5. Measure the patio floor to the underside of the gutter (if there is one)
 6. Measure the width of your patio or decking
 7. Measure the length of your patio or decking
- 🕒 Which direction does your garden face?



WHICH DIRECTION IS YOUR GARDEN FACING?

Whether your pergola will be against your home or freestanding, it's important to note which direction your garden faces. This will determine which pergola is most suitable for your space, giving you maximum sunlight and shade when required.

FREESTANDING SPACE

1. Measure the width of your patio or decking
 2. Measure the length of your patio or decking
- 🕒 Which direction does your garden face?

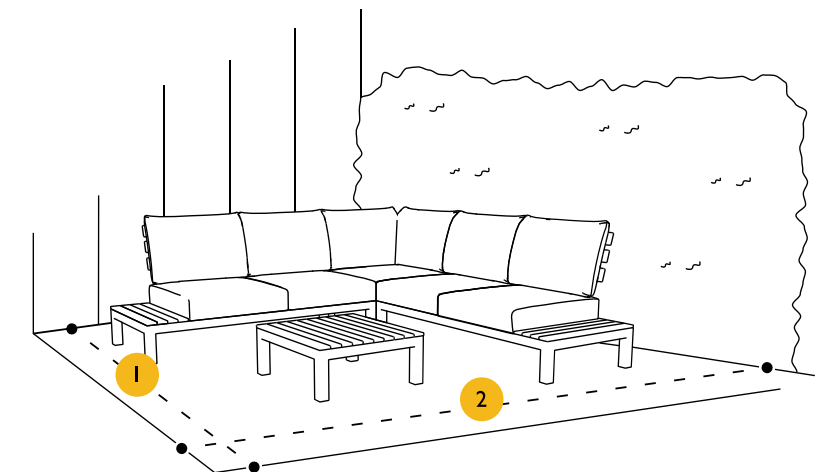







PERGOLA COMPARISON GUIDE

NEED SOME HELP?



Our expert team are on hand to answer any questions you might have, simply pop an email to info@sunslifestyle.com or call us on 01277 321888 and we'll happily answer any questions or queries.

	MARANZA	ROTA	ALVARO
COLOUR	 	 	 
SIZE (M)	3.0X3.0 – 4 LEGS 3.0X3.6 – 4 LEGS 3.5X3.6 – 4 LEGS 3.5X5.4 – 6 LEGS 3.5X7.2 – 6 LEGS	3.0X3.0 – 4 LEGS 3.0X3.6 – 4 LEGS 3.0X4.0 – 4 LEGS 3.6X3.6 – 4 LEGS 3.6X4.0 – 4 LEGS 3.0X6.0 – 6 LEGS 3.6X5.3 – 6 LEGS 3.6X6.0 – 6 LEGS 3.6X7.2 – 6 LEGS	From 3.6X3.0 – 4 LEGS 3.6X4.0 – 4 LEGS Infinite size extension by connecting above models Larger configurations require more legs for a safe structure
 Please note all measurements are in metres			
HEIGHT (M)	2.3 Height can be reduced*	2.5 Height can be reduced*	2.5 Height can be reduced*
DELUXE SCREENS Optional extra	✓	✓	✓
VENTED PANELS Optional extra	✓	✗	✓
SOLID PANELS Optional extra	✗	✗	✓
FREESTANDING	✓	✓	✓
WALL MOUNTED	6 leg models can remove middle leg for flush wall-mounted fit**	All models can remove legs for flush wall-mounted fit**	All models can remove legs for flush wall-mounted fit**
DIRECTION OF LOUVERS	LENGTHWAYS	WIDTHWAYS	WIDTHWAYS
DRAINAGE LOCATION	CORNER LEGS	ALL LEGS	ALL LEGS
REMOVE MIDDLE LEG Models with six legs and above only	✓ If securing over doors or windows, consider replacing the middle leg with a wall bracket*	✓ If securing over doors or windows, consider replacing the middle leg with a wall bracket*	✓ If securing over doors or windows, consider replacing the middle leg with a wall bracket*
NUMBER OF ROOF SECTIONS	4 LEGS — 2 Sections 3.5 X 5.4 — 3 Sections 3.5 X 7.2 — 4 Sections	4 LEGS — 1 Section 6 LEGS — 2 Sections	1 Section per pergola used in configuration

*Subject to additional cost
**Removing legs limits screen options

OUR PERGOLA PROMISE

Suns Lifestyle offers a reassuring warranty that stretches beyond legislation – with all pergolas having a 5-year warranty. If a part should defect due to a manufacturing fault or fail due to regular domestic use, Suns Lifestyle will either repair the defect at discretion, refinish the product or replace the defective part.



UNDER THE PERGOLA

Complete your outdoor space with our weatherproof lounge, dining, lighting and textiles collections designed for life in all seasons. Made using high quality, innovative materials and created with low-maintenance comfort in mind, you'll find everything you need to create a haven from home.

*Images show:
MONTE VARI FIREPIT & NAPPA DINING
COLLECTION, teak tabletop, with Macrame Weave
Nappa dining chairs, in Light Anthracite Mixed Weave*

DISCOVER MORE



Scan here to shop our full collection of outdoor furniture and accessories.

DINING COLLECTIONS

Gather with friends and family to enjoy al fresco dining in style. Our flexible range of dining collections are made from premium quality, weatherproof materials to provide ultimate comfort, for long lazy lunches or evenings spent entertaining outdoors.



Images show:

Top Left; OVADA & NAPPA DINING COLLECTION, top right; OVADA DINING BENCH COLLECTION, bottom; RIALTO & MATERA DINING COLLECTION, right; RIALTO & NAPPA DINING COLLECTION

Discover our full range of styles, colours and configurations online.



SCAN TO EXPLORE



LOUNGE COLLECTIONS

Upgrade your outdoor space and unwind in style with a Suns Lifestyle Lounge Collection. These exclusively designed pieces with deep comfy cushions are fully weatherproof, so you're guaranteed to be garden ready come rain or shine.

Alternative fabric colours and configurations are available for all Lounge Collections (excluding the Vita Collection) subject to longer lead times.

Image shows:
SAVONA LOUNGE COLLECTION in Matt Royal Grey aluminium with Light Anthracite Mixed Weave cushions





Discover our full range of styles, colours and configurations online.



SCAN TO EXPLORE

SOFA COLLECTIONS

Our exclusively designed sofa collections offer the comfiest cushions you'll find outdoors. Featuring Quick-dry® foam interiors and upholstered in innovative fade and mould-resistant weatherproof fabric, they're ready to use quickly after a downpour.

Alternative fabric colours and configurations are available for all sofa collections, speak to our team for more options.

Image shows:
SAVONA SOFA COLLECTION
Matt White aluminium with Soft Grey
Mixed Weave cushions



FIRE FEATURES

Add real warmth and atmosphere to evening's spent outdoors; our bar, dining and lounge fire table collections feature integrated gas firepits* to create the ultimate all-season ambience.

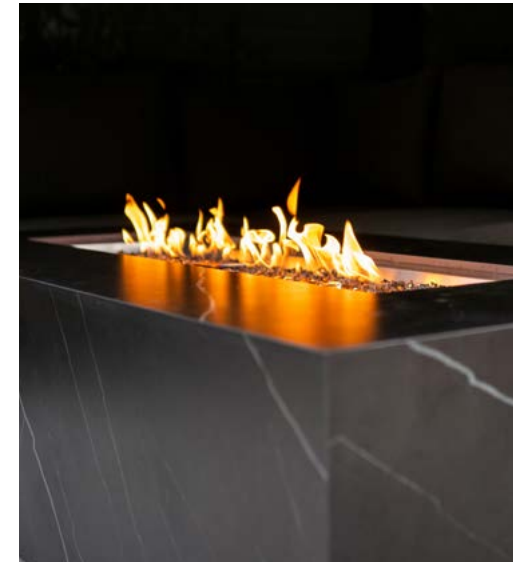
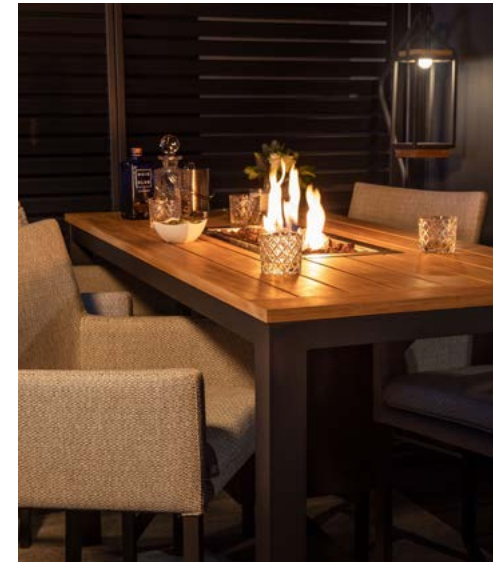

Images show:
 Left; POSITANO FIRE TABLE, top Left; MONTE VARI FIREPIT WITH ANTAS BAR COLLECTION, top right; VICTORIA FIRE TABLE, bottom; MONTE VARI FIREPIT & NAPPA DINING COLLECTION

*Gas bottle not included

DAYBEDS

The daybed perfectly captures the laid-back and luxurious style of the Balearic Islands. With generous oversized cushions, there's plenty of space to spread out - the epitome of outdoor lounging.

Alternative fabric colours and configurations are available for all daybeds subject to longer lead times.

Image shows:
EVORA DAYBED in Matt Royal Grey aluminium with Light Anthracite Mixed Weave cushions, styled with the **COSA SCATTER CUSHION** in Light Grey Mix



LOUNGERS

The must-have piece of outdoor furniture. Get ready to soak up that sunshine in style with our glorious range of high-quality sun loungers. All fully weatherproof and height adjustable.



Images show:
Top; TUTTI LOUNGER, bottom; MARINO LOUNGER, right; NARDO LOUNGER

PARASOLS

Create some shade on long hot days in your garden with the luxurious and robust Palmoli square parasol.

Image shows:
PALMOLI SQUARE PARASOL
Matt Royal Grey Aluminium
with Camel Sand Fabric



LIGHTING AND ACCESSORIES

Bring the indoors out and complete your garden with our solar-powered lighting and outdoor textile collections. Create cosy corners with FSC teak-framed lanterns, offering 18 hours of illumination on full charge. Or add the perfect finishing touches with super soft cushions and weatherproof rugs, available in a range of sizes and colours - each made using recycled PET bottle fibres for a conscious and considered outdoor space.

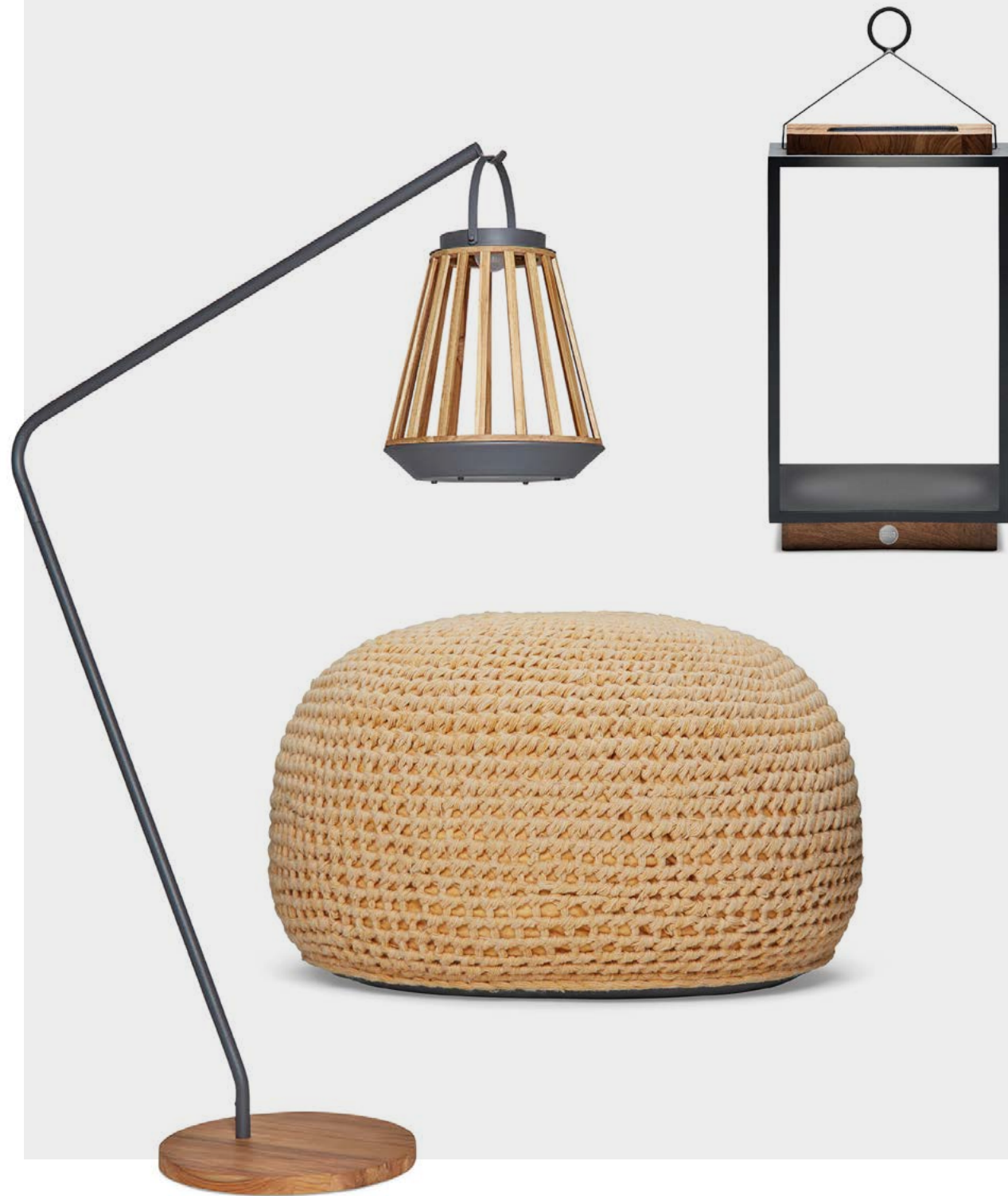

Discover our full range of styles, colours and configurations online.



SCAN TO EXPLORE



PRODUCT QUALITY

WE TAKE PRIDE
IN OUR PRODUCTS

Suns Lifestyle exclusively works with the best durable materials for outdoor use, each component is built to last. Our products are designed for life outdoors; fully-weatherproof and easy to maintain. Across the range, you'll spot innovative benefits like scratch and wear resistance, mould-resistance and UV-protective treatments to our fabrics.

ALUMINIUM

Suns Lifestyle uses robust, industrial-grade aluminium to ensure solid construction. Our powder coating finish adds a beautiful look and provides an extra-long lifespan.

TEAK & ROPE

FSC-certified teak wood is sustainably sourced, long-lasting and designed to withstand harsh weather conditions.



We work with consciously-sourced, FSC-certified teak originating from environmentally controlled plantations. Weatherproof by nature, thanks to its inherent oils - our teak is mould and insect resistant. We only use high grade teak for our outdoor furniture, treat every season with our gentle wood protector to keep the warmer honey tones or let nature take its course and allow the teak to weather to a beautifully soft silver over time.

Weatherproof and easy to clean, our high-quality marine grade rope is double braided and shape retaining. Not only does it create a wonderfully supportive frame for our chairs and sofas, it looks great too. Available in a variety of colours and woven with fade-resistant Sunproof® fibres.

FABRICS

MADE TO LAST

TEXTILENE

Textilene is a strong, stable and UV-protective nylon-coated material which is extremely durable and easy to clean. Our Deluxe pergola screens feature double-layered Textilene for low maintenance, robust protection from the wind, rain and sun.

SUNPROOF®

This premium material is completely weatherproof, extremely colourfast, easy to clean and wonderfully soft. We feature it on our dining, lounge and daybed collections for comfort and quality you'd usually only find indoors.

QUICK DRY FOAM®

Quick-dry foam® has an open cell structure that does not retain water, the enhanced air circulation allows rainwater to run through it easily meaning your furniture will be ready for use again shortly after a downpour.

WATER REPELLENT CUSHIONS

You can't always be on time to take your cushions inside for every change of weather. Our water repellent cushions can be used within hours of a downfall.

STRONG AND SUSTAINABLE

Suns Lifestyle outdoor textile collections are made from PET-recycled plastic fibres. Transforming plastic bottles into the softest, most durable textiles you'll find outdoors. Thanks to the plastic properties, each rug and cushion in our collection is weather-resistant too. Perfect for adding the finishing touches to any outdoor space.



abbey
Awnings

01189 817 300

www.abbeyawnings.co.uk

**5-YEAR
WARRANTY**
on Pergola's and
Furniture

**2-YEAR
WARRANTY**
on all screens
and panels

SUN'S
L I F E S T Y L E